

CUES Rear Derailleur

RD-U6020-11 (SGS) 11-speed
RD-U6020-10 (SGS) 10-speed

RD-U4020-SGS 9-speed
RD-U3020-SGS 9-speed

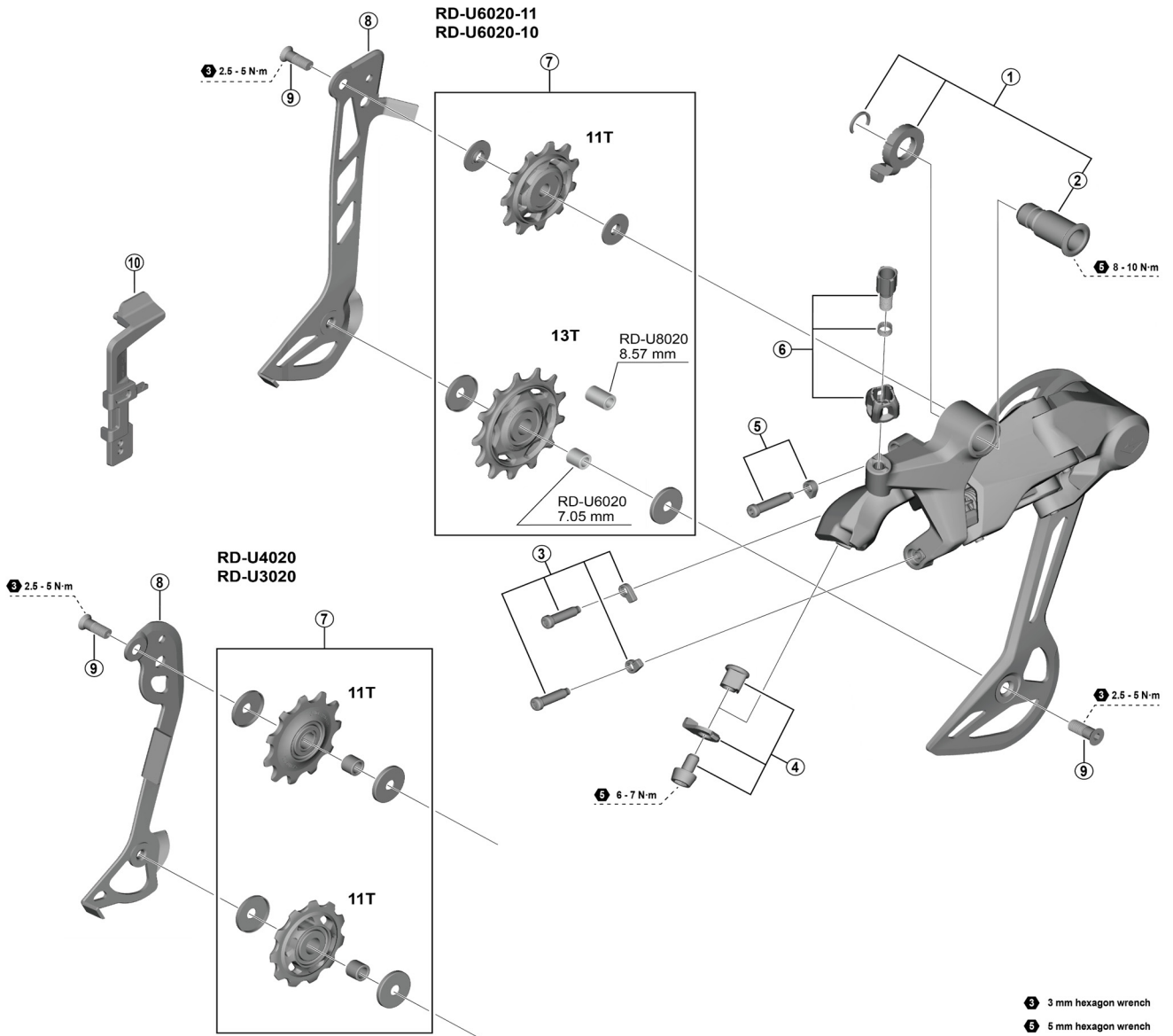

ITEM NO.	SHIMANO CODE NO.	DESCRIPTION	INTERCHANGEABILITY				
			RD-U6020	RD-U6020-11	RD-U6020-10	RD-U4020	RD-U3020
1	Y3JE98020	Mounting screw (used for RD-U8020)	A	B	B	B	B
2	Y3JE9801T	Mounting screw (used for RD-U8020)	A	B	B	B	B
3	Y3JE98050	Stroke adjusting screws and plate (used for RD-U8020)	A	B	B	B	B
4	Y3JE98060	Cable fixing bolt unit (used for RD-U8020)	A	B	B	B	B
5	Y3JH98010	End adjust screw (M4 x 18) and plate (used for RD-U6020)		A	A	B	B
6	Y3JD98070	Cable adjustment barrel unit (used for RD-U8020)	A	B	B	B	B
* 7	Y3JE98010	Tension and guide pulley set for RD-U6020-11 / RD-U6020-10 (used for RD-U8020)	A	B	B		
	Y3JK98010	Tension and guide pulley set for RD-U4020 / RD-U3020				A	A
	Y3JE9804T	Inner plate (SGS) for RD-U6020-11 (used for RD-U8020)	A	B			
8	Y3JJ9801T	Inner plate (SGS) for RD-U6020-10			A		
	Y3JK9801T	Inner plate (SGS) for RD-U4020 / RD-U3020				A	A
9	Y3HM98080	Pulley screw (2 pcs.)		A	A	A	A
* 10	Y07A98020	TL-RD200 G-pulley setting tool	A	A	A	A	A

A: Same parts.

B: Parts are usable, but differ in materials, appearance, finish, size, etc.

Absence of mark indicates non-interchangeability.

Specifications are subject to change without notice.

Torque information is listed.

Jun.-2023-4959A

© Shimano Inc. I

SHIMANO