

Front Chainwheel FC-T551

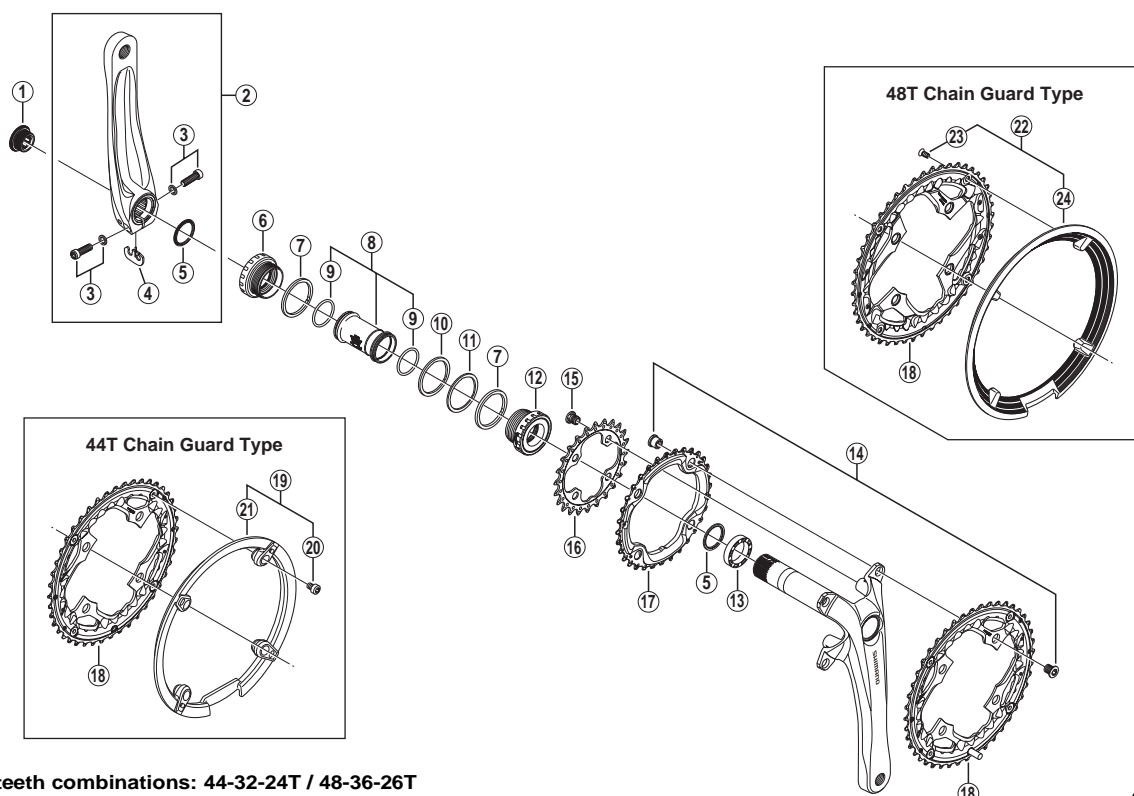

- Chaining teeth combinations: 44-32-24T / 48-36-26T
- Bolt circle diameter: 104 mm...(For outer gear and middle gear), 64 mm...(For inner gear)

FC-T780
FC-T781

ITEM NO.	SHIMANO CODE NO.	DESCRIPTION	INTERCHANGEABILITY	
			FC-T780	FC-T781
1	Y1F811100	Crank Arm Fixing Bolt	B	B
2	Y1MX98010	Left Hand Crank Arm 170 mm (Silver)	B	B
	Y1JB98020	Left Hand Crank Arm 170 mm (Black)	B	B
	Y1MX98020	Left Hand Crank Arm 175 mm (Silver)	B	B
	Y1JB98040	Left Hand Crank Arm 175 mm (Black)	B	B
3	Y1KS98030	Clamp Bolt (M6 x 19) & Washer	A	A
4	Y1FU98120	Plate	A	A
5	Y1F316000	Ring	A	A
6	Y1LD98060	Left Hand Adapter (B.C.1.37" x 24T) English Thread	B	B
7	Y1F813000	Spacer (2.5 mm)	A	A
8	Y1J898060	Inner Cover & O-Ring	B	B
9	Y1TF21000	O-Ring	A	A
10	Y1F813100	Spacer (1.8 mm)		A
11	Y1F813110	Spacer (0.7 mm)		A
12	Y1LD98070	Right Hand Adapter (B.C.1.37" x 24T) English Thread	B	B
13	Y1F913000	Spacer (6.5 mm)	A	A
14	Y1MZ98010	44-32T Double Gear Fixing Bolt (M8 x 8.5) & Nut (4 sets)	B	B
	Y1LV98050	48-36T Double Gear Fixing Bolt (M8 x 8.5) & Nut (4 sets)	B	B
15	Y1LV98060	Inner Gear Fixing Bolt (M8 x 8.5 / 4 pcs.)	B	B
16	Y1MX24000	Chaining 24T-AE	B	B
	Y1FV26000	Chaining 26T	B	B
17	Y1MX98030	Chaining 32T-AE	B	B
	Y1MX98040	Chaining 36T-AL	B	B
	Y1MX98050	Chaining 44T-AE	A	A
18	Y1MX98060	Chaining 44T-AE for Chain Guard	A	A
	Y1MX98070	Chaining 48T-AL	B	B
	Y1MX98080	Chaining 48T-AL for Chain Guard	B	B
19	Y1M098250	44T Chain Guard & Fixing Bolts	B	B
20	Y1M098260	44T Chain Guard Fixing Bolt (4 pcs.)	B	B
21	Y1GX14100	44T Chain Guard	B	B
22	Y1LD98140	48T Chain Guard & Fixing Bolts	B	B
23	Y1D298010	48T Chain Guard Fixing Bolt (4 pcs.)	B	B
24	Y1LD12000	48T Chain Guard	B	B

A: Same parts.

B: Parts are usable, but differ in materials, appearance, finish, size, etc.

Absence of mark indicates non-interchangeability.

Aug.-2011-3247

© Shimano Inc. I