

DEORE Shifting Lever (I-spec EV)

SL-M5100-I (2/1x11-speed)

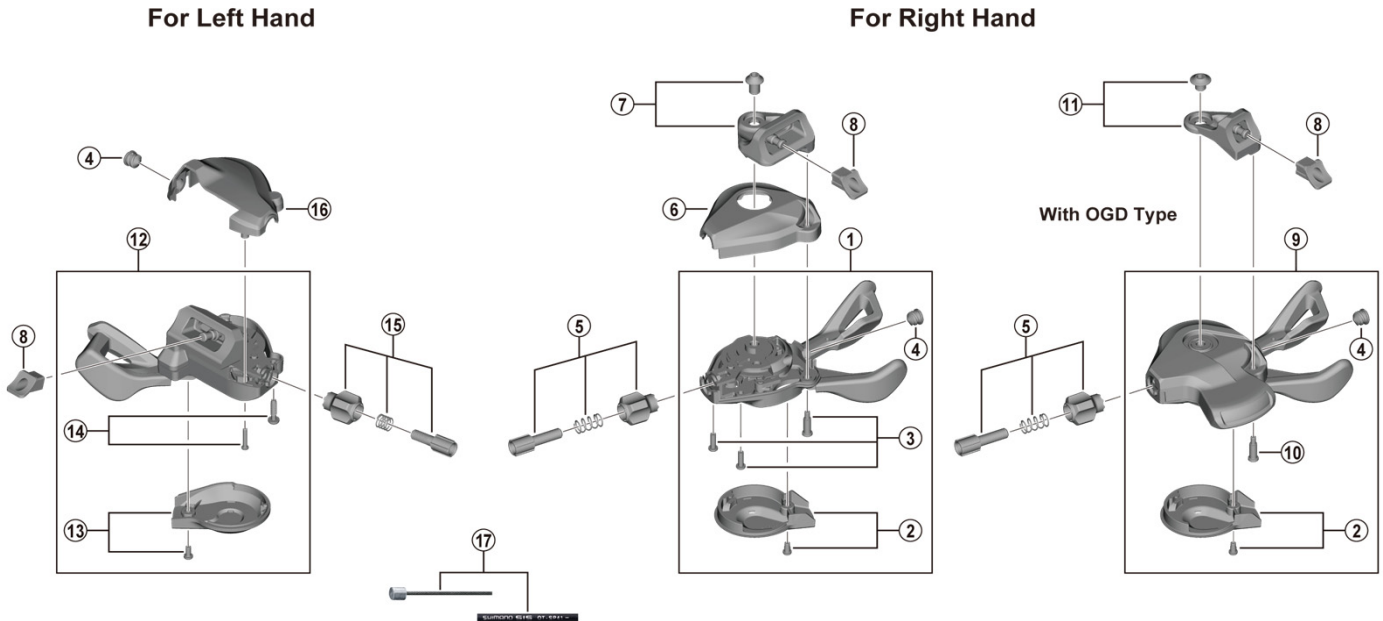

ITEM NO.	SHIMANO CODE NO.	DESCRIPTION
1	Y0L898010	R.H. Shifting Lever Unit
2	Y0L098020	R.H. Main Lever Cover & Fixing Screw
3	Y0L098030	R.H. Base Cover Fixing Screw Unit
4	Y6CD33000	Inner Hole Cap
5	Y6TA98020	R.H. Cable Adjustment Barrel Unit
6	Y0L801000	R.H. Base Cover
7	Y0L898040	R.H. Bracket Unit
8	Y0GT10000	Integration Nut
9	Y0L898030	R.H. Shifting Lever Unit for With OGD Type
10	Y0L010000	M2.5 Screw
11	Y0L898050	R.H. Bracket Unit for With OGD Type
12	Y0L998040	L.H. Shifting Lever Unit
13	Y0L998050	L.H. Main Lever Cover & Fixing Screw
14	Y0L998030	L.H. Upper Cover Fixing Screw Unit
15	Y6PZ98070	L.H. Cable Adjustment Barrel Unit
16	Y0L900050	L.H. Upper Cover
17	Y60198090	OT-SP41 OPTISLICK shift cable sets (Black) <ul style="list-style-type: none"> • Sealed outer caps, plastic (9 pcs.) • Sealed outer cap nose (1 pc.) • Rubber shield (1 pc.) • Inner end caps (2 pcs.)
	Y60198091	OT-SP41 OPTISLICK shift cable sets (White) <ul style="list-style-type: none"> • Sealed outer caps, plastic (9 pcs.) • Sealed outer cap nose (1 pc.) • Rubber shield (1 pc.) • Inner end caps (2 pcs.)

Jun.-2020-4753
© Shimano Inc. I

Specifications are subject to change without notice.

SHIMANO