

DEORE Rapidfire Plus Lever

SL-M6000-I I-spec II (3/2x10-speed)

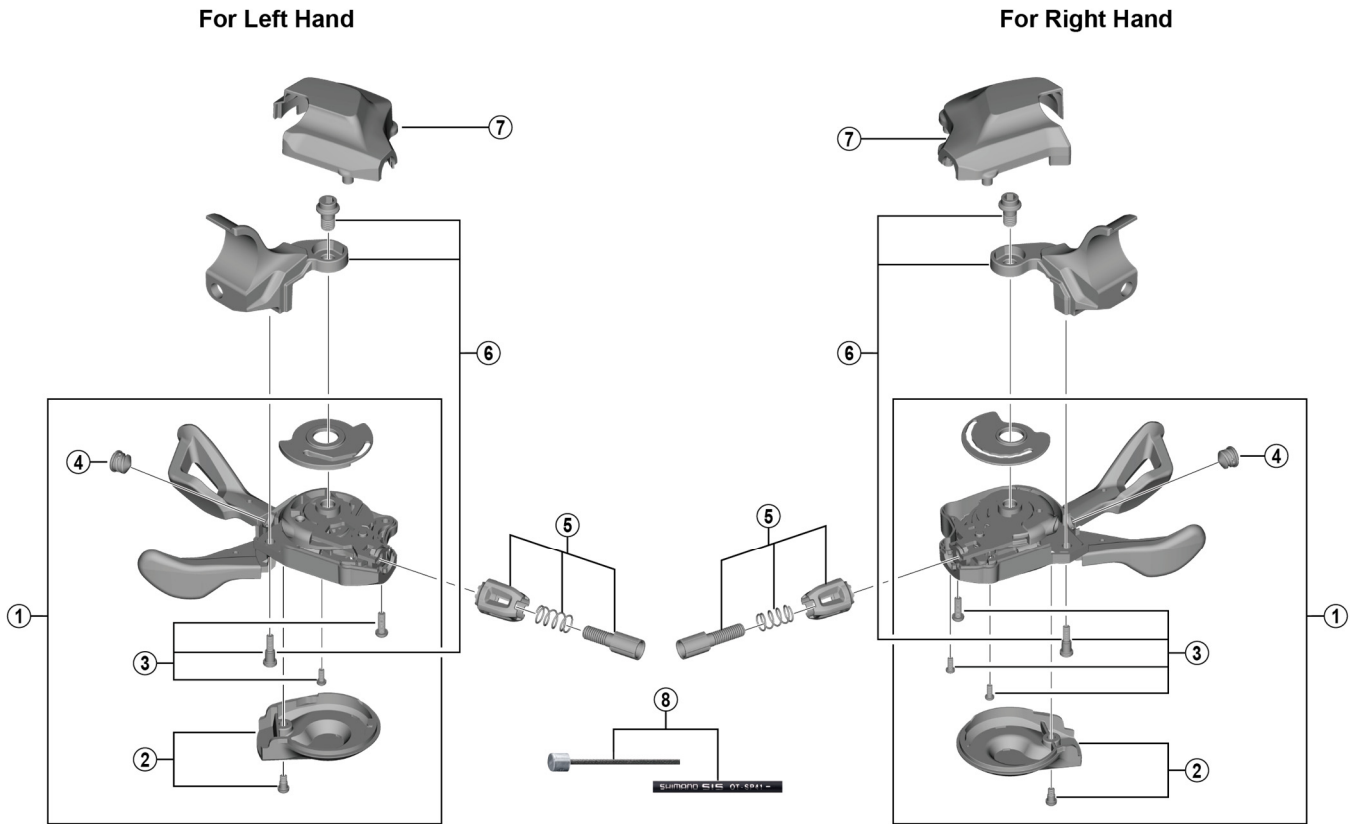

ITEM NO.	SHIMANO CODE NO.	DESCRIPTION
1	Y0CR98010	R.H. Shifting Lever Unit
	Y0CS98010	L.H. Shifting Lever Unit
2	Y0CR98020	R.H. Main Lever Cover & Fixing Screw
	Y0CS98020	L.H. Main Lever Cover & Fixing Screw
3	Y0CR98070	R.H. Base Cover Fixing Screw Unit
	Y0CS98070	L.H. Base Cover Fixing Screw Unit
4	Y6CD33000	Inner Hole Cap
5	Y03K98030	R.H. Cable Adjusting Bolt Unit
	Y06N98040	L.H. Cable Adjusting Bolt Unit
6	Y0CR98060	R.H. Bracket & Fixing Bolt
	Y0CS98060	L.H. Bracket & Fixing Bolt
7	Y0CR21000	R.H. Base Cap
	Y0CS71000	L.H. Base Cap
8	Y60198090	OT-SP41 OPTISLICK shift cable sets (Black) <ul style="list-style-type: none"> • Sealed outer caps, plastic (9 pcs.) • Sealed outer cap nose (1 pc.) • Rubber shield (1 pc.) • Inner end caps (2 pcs.)
	Y60198091	OT-SP41 OPTISLICK shift cable sets (White) <ul style="list-style-type: none"> • Sealed outer caps, plastic (9 pcs.) • Sealed outer cap nose (1 pc.) • Rubber shield (1 pc.) • Inner end caps (2 pcs.)

May-2017-4190

© Shimano Inc. I

Specifications are subject to change without notice.

SHIMANO